

*DAMAC*  
**BAY2**  
BY CAVALLI

LOOK OUT TOWARDS THE SEA

WITHIN

AND FEEL THE DEPTH

LOOK INSIDE YOURSELF

AND HEAR THE CALL OF THE WILD



HEAR THE EXOTIC  
CALL OF THE WILD.

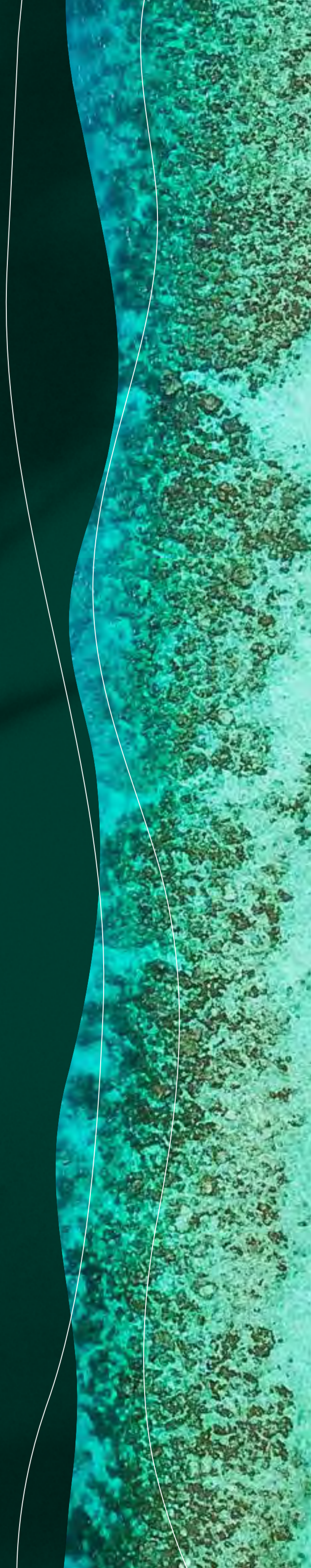

An aerial photograph of a small white boat on a vast expanse of turquoise water. The water's surface is textured with ripples and reflects the sky. The boat is positioned in the lower-middle part of the frame, moving towards the right. The overall color palette is dominated by various shades of blue and green, creating a serene and natural atmosphere.

A WAY OF LIVING  
CONCEALED FOR SO  
LONG, UNTOUCHED  
AND UNTAMED.



NOW,  
AN ALLURING,  
CAVALLI-INSPIRED  
LIFESTYLE IS  
READY TO REVEAL  
ITSELF.



THIS IS  
PARADISE FOUND.

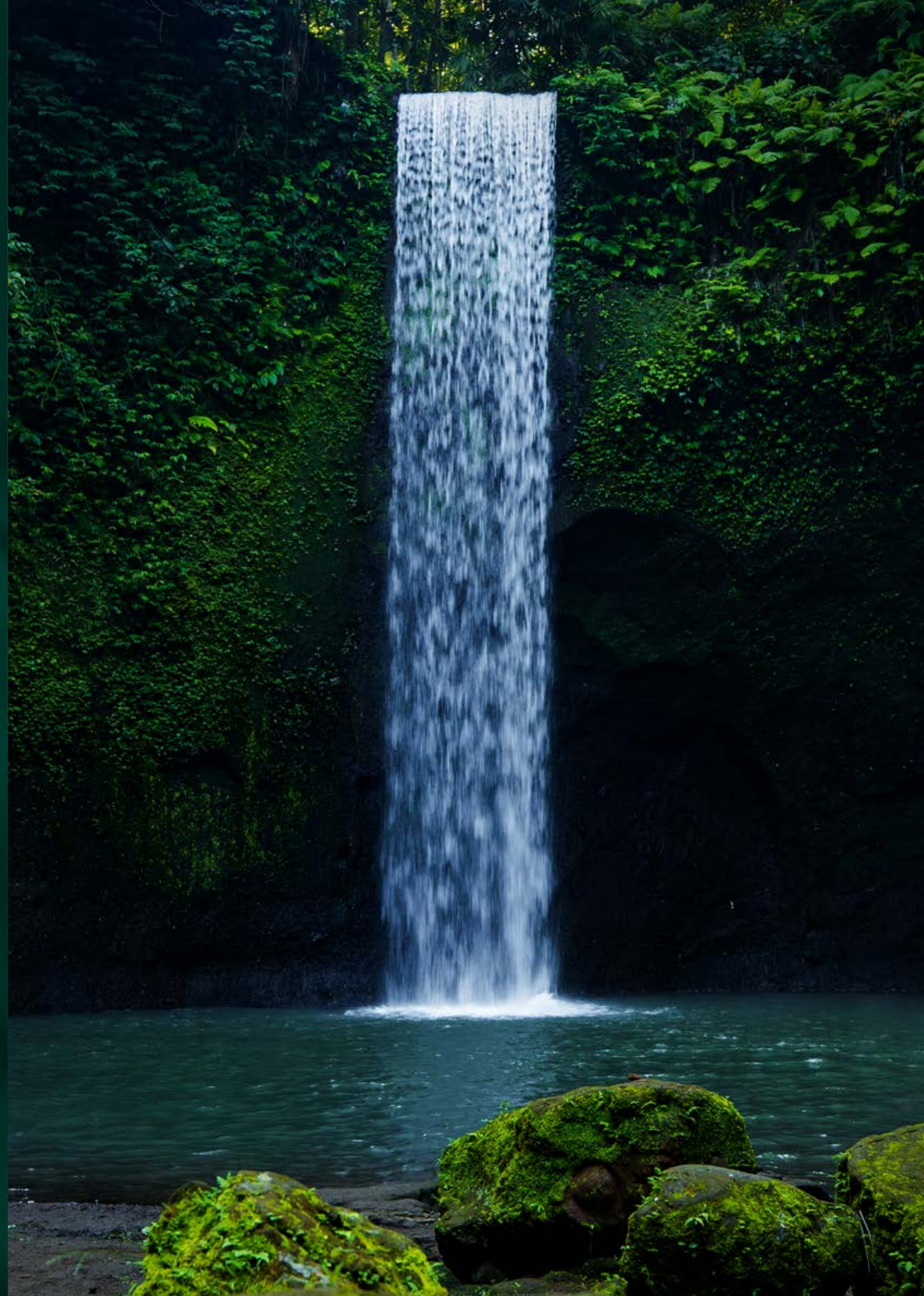

PRESENTING

*DAMAC*

# BAY 2

BY CAVALLI

WHERE YOUR  
WILD SIDE MEETS  
THE SEA.





DAMAC  
**BAY2**  
BY CAVALLI

## FIND YOUR WAY TO DUBAI HARBOUR

Welcome to one of the region's most unique seafront districts. Dubai Harbour is at the intersection of the iconic Palm Jumeirah and Bluewaters, equidistant from Dubai International Airport and Al Maktoum International Airport and only minutes away from some of the city's most-loved landmarks, beautiful beaches and world-famous attractions.

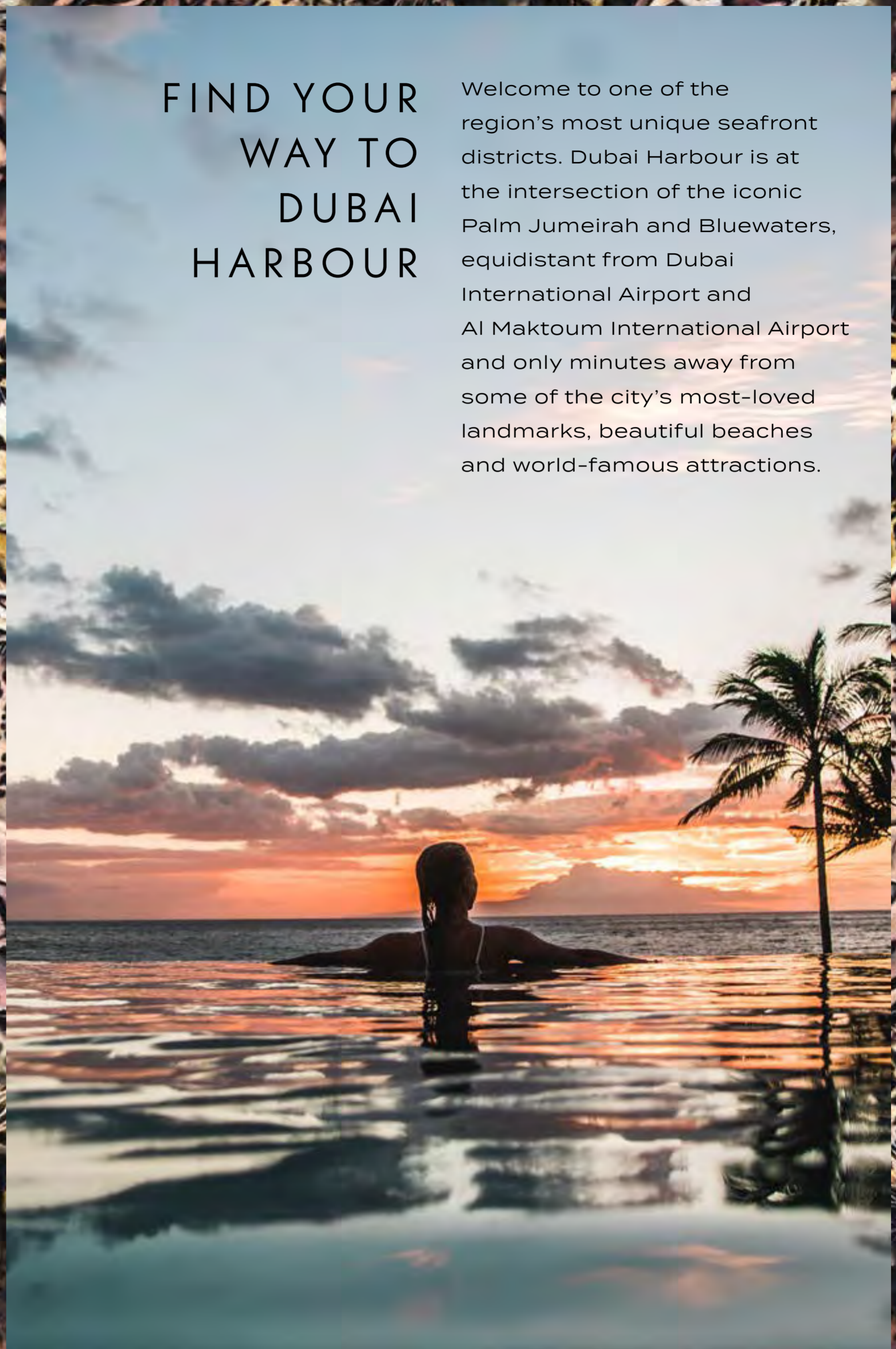

DAMAC  
**BAY2**  
BY CAVALLI

DAMAC  
**BAY**  
BY CAVALLI





## YOUR COUTURE-INSPIRED LIFESTYLE

With DAMAC Bay we brought you the call of the sea. Now, with DAMAC Bay 2, feel fierce creativity unleashed next door, as Cavalli's iconic, nature-inspired fashion awakens your wild side.

**cavalli**



# LUXURY BECOMES SECOND NATURE

A soothing and striking 49-storey property that spirits you away to the life you deserve.

Feel harmony and exhilaration in the presence of this dynamic and distinct paragon of luxury living, a sequel that feels alive.



# LUXURY IS ON THE HORIZON

Enter into a glistening lobby with textured surroundings, including bedazzling chandeliers, earthy, rustic accents, muted tones and opulent marble finishes.







# YOUR SANCTUARY OF SPLENDOUR

Celebrate life in a home that abounds with space, a magical and lavish escape full of serene and natural colours that inspire the soul.

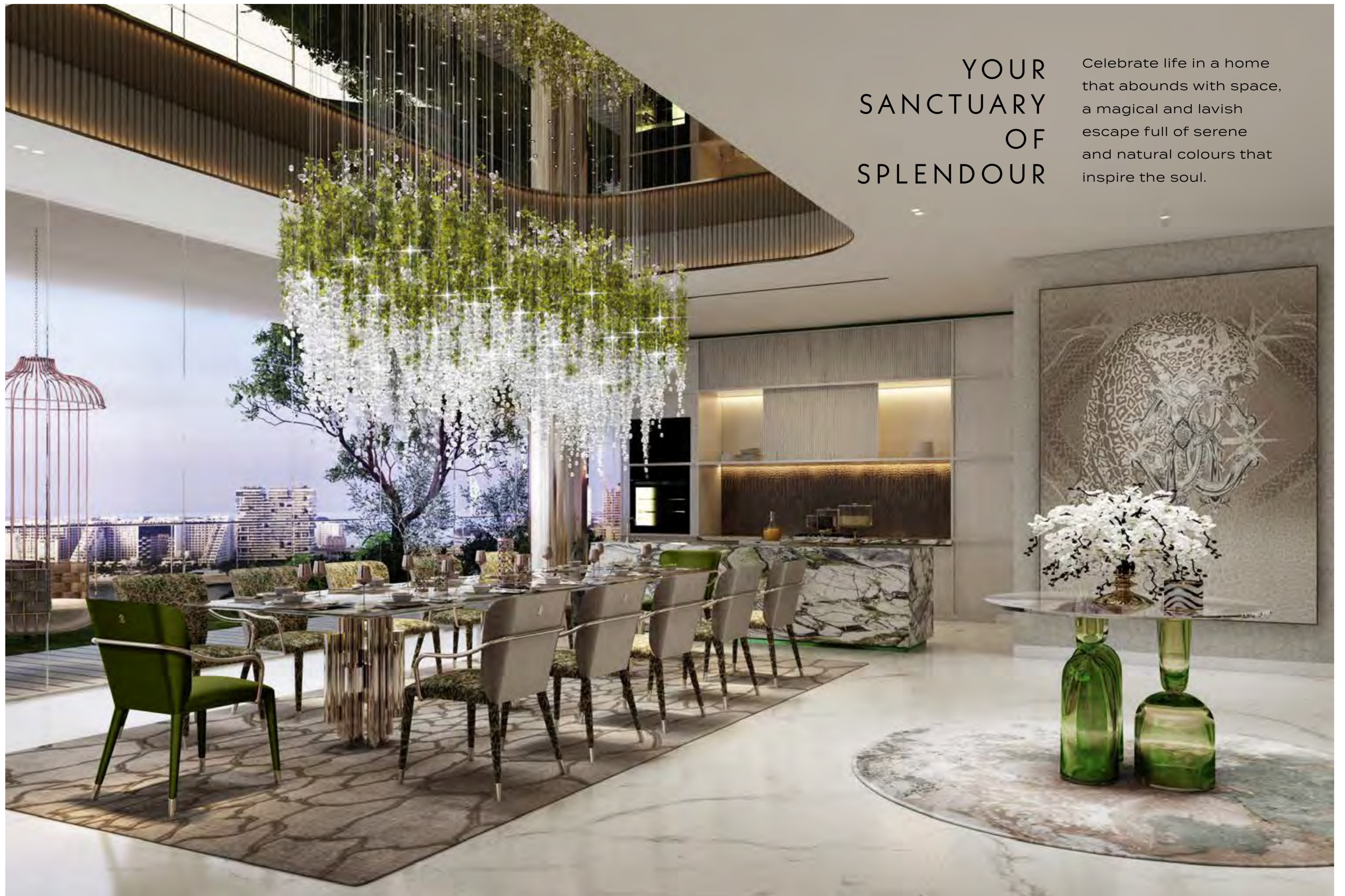















EXPLORE A  
VERDANT AND VIVID  
ENVIRONMENT FULL  
OF AMENITIES THAT  
INSPIRE MYSTERY,  
WONDER AND  
ENCHANTMENT.







## WHERE YOUR WORRIES FLOAT AWAY

From floating relaxation pods and glamping tents, where you can enjoy beauty and body treatments, to wading in the pool sipping your favourite mocktail, DAMAC Bay 2 is the perfect place to live the luxury.

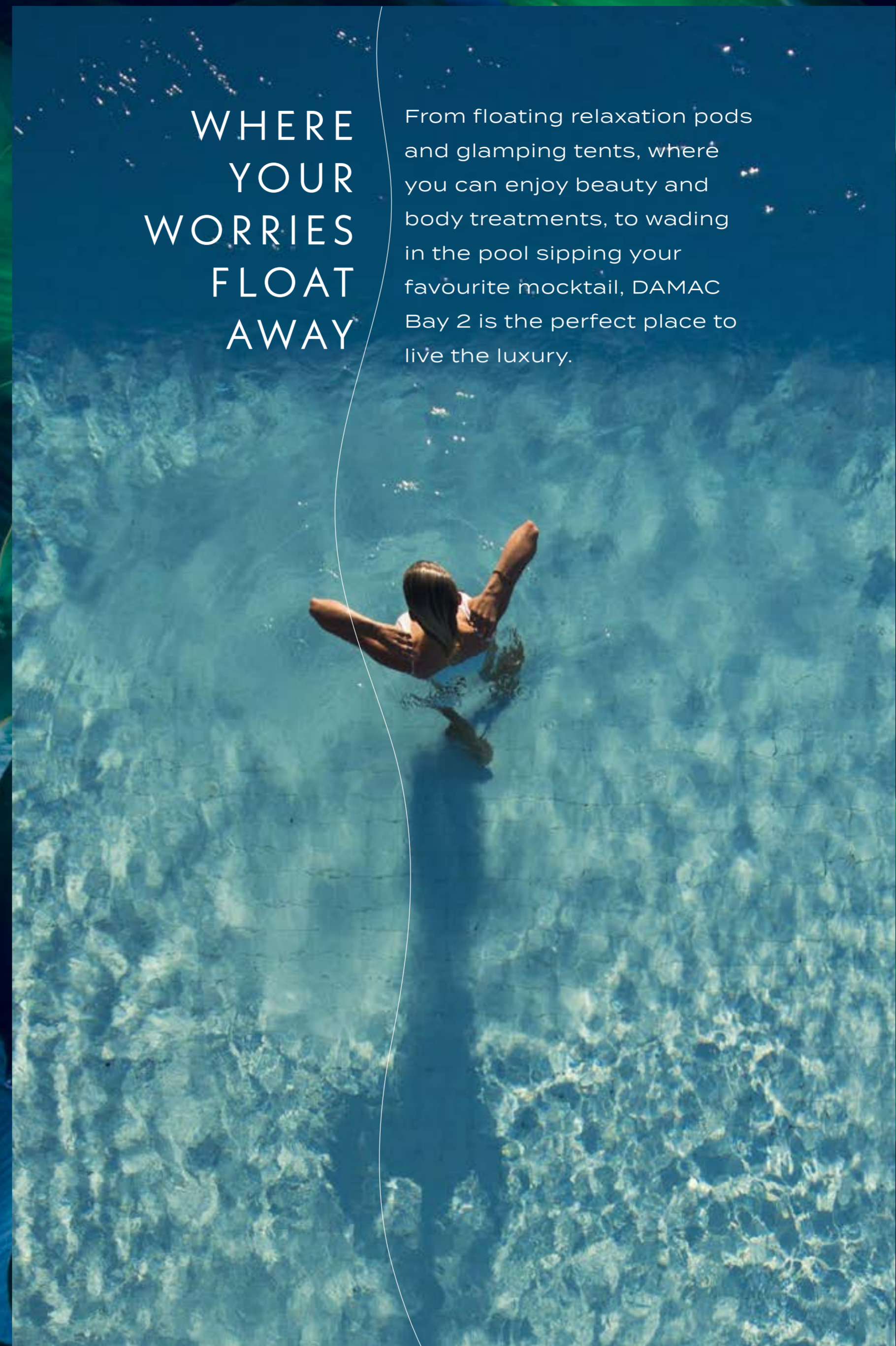







# GO WITH THE FLOW

Feel your worries sail away as you experience a sense of balance and wellbeing with a myriad of aqua treatments, including hydrotherapy walkthrough showers and hot tub boats.





## EMBRACE YOUR INNER FASHIONISTA

Try on multiple outfits in a virtual fitting room, explore the latest Roberto Cavalli trends and collections at the Cavalli Museum and pour your inspiration into a customised Cavalli fashion masterpiece at the Cavalli Art and Fashion Studio.



THE HEIGHT OF  
HEAVENLY LUXURY



ANOTHER  
LEVEL  
OF BLISS

On the 43rd level, find even more amenities that bring this unique world to life, effortlessly blending art and nature, including DAMAC Bay 2's infinity pool, ensuring your feelings of serenity stretch on forever.



## LISTEN TO YOUR DREAMS

At DAMAC Bay 2, escape into a space where you can grow and transform, limited only by your imagination. Lay back in luxurious comfort as you explore zero gravity with our dream pods, or immerse yourself in a one-of-a-kind music experience with colossal step-in speakers.







# CRADLES OF WEIGHTLESS SOLITUDE

Feel a sense of stillness and find your stress melt away as you're suspended in profound silence in DAMAC Bay 2's flotation therapy pods.



# A NATURALLY VIBRANT JUNGLE OASIS

Spend some time in the DAMAC BAY 2 spa, with its peaceful tropical treatment rooms mirroring the captivating essence of the wild, including a cocooned banana leaf body wrap that treats both your body and mind.









## CAVALLI- INSPIRED GASTRONOMY

Enjoy a colourful array of fragrant dishes at the sushi bar where you can indulge in sensational flavours and textures carefully crafted by skilled chefs who take pride in their creations.





SUPER-LUXURY  
UNIT PLANS

# 5-BEDROOM SUPER-LUXURY

TYPE A



LOWER LEVEL

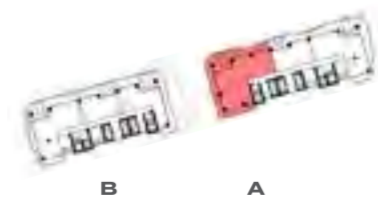

**SUPER-LUXURY LOWER  
TOWER A**  
LEVEL:  
44

# 5-BEDROOM SUPER-LUXURY

TYPE A



UPPER LEVEL

# 5-BEDROOM SUPER-LUXURY

TYPE B



LOWER LEVEL

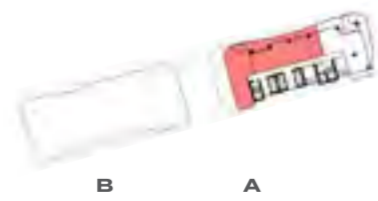

**SUPER-LUXURY LOWER TOWER A**  
LEVEL:  
48

# 5-BEDROOM SUPER-LUXURY

TYPE B



UPPER LEVEL



**SUPER-LUXURY LOWER TOWER A**  
LEVEL:  
48

# 4-BEDROOM SUPER-LUXURY

TYPE A



LOWER LEVEL

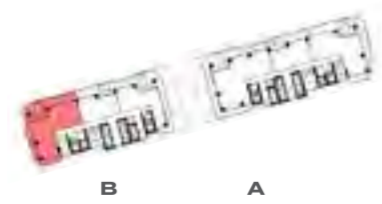

**SUPER-LUXURY LOWER TOWER B**  
LEVEL:  
44

# 4-BEDROOM SUPER-LUXURY

TYPE A



UPPER LEVEL

# 4-BEDROOM SUPER-LUXURY

TYPE B



LOWER LEVEL

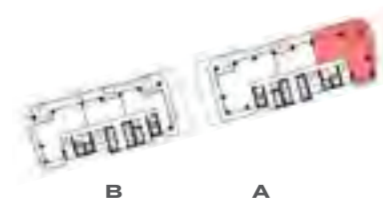

**SUPER-LUXURY  
TOWER A**  
LEVEL:  
44

# 4-BEDROOM SUPER-LUXURY

TYPE B



UPPER LEVEL

# 4-BEDROOM SUPER-LUXURY

TYPE C



LOWER LEVEL

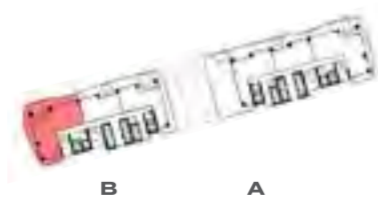

**SUPER-LUXURY  
TOWER B**  
LEVEL:  
46

# 4-BEDROOM SUPER-LUXURY

TYPE C



UPPER LEVEL

# 4-BEDROOM SUPER-LUXURY

TYPE D



LOWER LEVEL



**SUPER-LUXURY  
TOWER A**  
LEVEL:  
46

# 4-BEDROOM SUPER-LUXURY

TYPE D



UPPER LEVEL

# 3-BEDROOM SUPER-LUXURY

TYPE A 01



LOWER LEVEL



**SUPER-LUXURY  
TOWER B**  
LEVEL:  
44

# 3-BEDROOM SUPER-LUXURY

TYPE A 01



UPPER LEVEL

# 3-BEDROOM SUPER-LUXURY

TYPE A 02



LOWER LEVEL



**SUPER-LUXURY  
TOWER A**  
LEVEL:  
44

# 3-BEDROOM SUPER-LUXURY

TYPE A 02



UPPER LEVEL

# 3-BEDROOM SUPER-LUXURY

TYPE A 03



LOWER LEVEL



**SUPER-LUXURY  
TOWER A**  
LEVEL:  
46

# 3-BEDROOM SUPER-LUXURY

TYPE A 03



UPPER LEVEL



# 3-BEDROOM SUPER-LUXURY

TYPE B 01



LOWER LEVEL

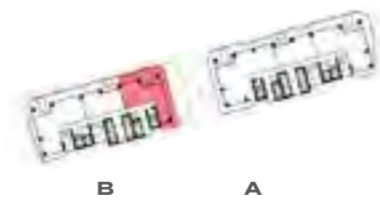

**SUPER-LUXURY  
TOWER B:  
LEVEL:  
44**

# 3-BEDROOM SUPER-LUXURY

TYPE B 01



UPPER LEVEL

# 3-BEDROOM SUPER-LUXURY

TYPE B 02



LOWER LEVEL

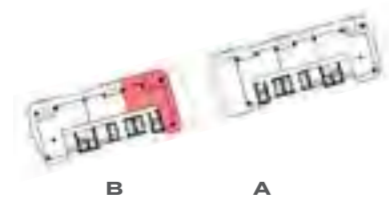

**SUPER-LUXURY  
TOWER B:  
LEVEL:  
46**

# 3-BEDROOM SUPER-LUXURY

TYPE B 02



UPPER LEVEL

# 3-BEDROOM SUPER-LUXURY

TYPE B 03



LOWER LEVEL

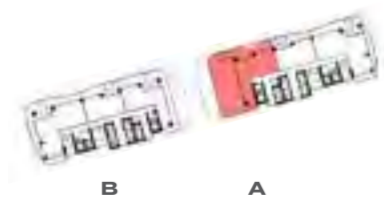

**SUPER-LUXURY  
TOWER A:  
LEVEL:  
46**

# 3-BEDROOM SUPER-LUXURY

TYPE B 03



UPPER LEVEL

# 3-BEDROOM SUPER-LUXURY

TYPE C



LOWER LEVEL



**SUPER-LUXURY  
TOWER A:  
LEVEL:  
48**

# 3-BEDROOM SUPER-LUXURY

TYPE C



UPPER LEVEL

An aerial photograph of a dense, lush green forest covering a steep hillside. The forest is vibrant and textured, with sunlight filtering through the canopy. On the right side of the image, there is a vertical strip showing the turquoise ocean with white-capped waves crashing against a dark, rocky shore. The text 'LUXURY UNIT PLANS' is centered in the left half of the image.

LUXURY  
UNIT PLANS

# 3-BEDROOM LUXURY

TYPE A 01

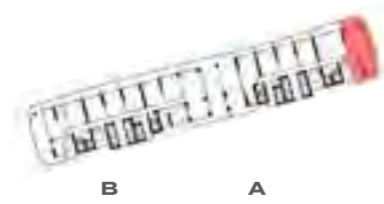

**SKY GARDEN TYPE 2**  
**TOWER A:**  
 LEVELS:  
 15,27

# 3-BEDROOM LUXURY

TYPE A 02



**BALCONY TYPE 1**  
**TOWER B:**  
 LEVELS:  
 12,26,36

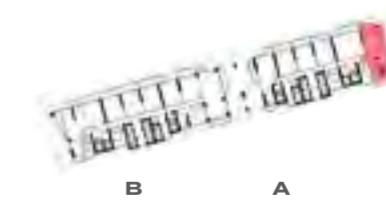

**BALCONY TYPE 4**  
**TOWER A:**  
 LEVELS:  
 3,7,18,30



# 3-BEDROOM LUXURY

TYPE A 05



**TOWER A:**  
LEVEL:  
2



**TOWER A:**  
LEVEL:  
37

# 3-BEDROOM LUXURY

TYPE A 06

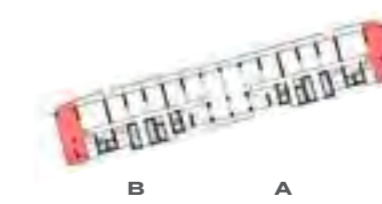

**TOWER A:**  
LEVEL:  
39

**TOWER B:**  
LEVEL:  
39

# 3-BEDROOM LUXURY

TYPE A 07



**TOWER A:**  
LEVELS:  
38, 41

**TOWER B:**  
LEVELS:  
38, 41

# 3-BEDROOM LUXURY

TYPE A 08

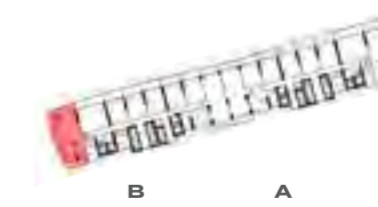

**TOWER B:**  
LEVEL:  
37

# 3-BEDROOM LUXURY

TYPE A 09

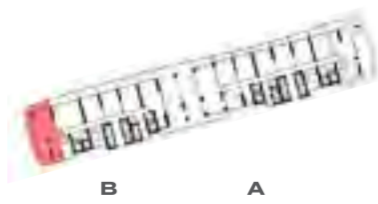

**SKY GARDEN TYPE 1**  
**TOWER B:**  
 LEVEL:  
 9

# 3-BEDROOM LUXURY

TYPE A 10

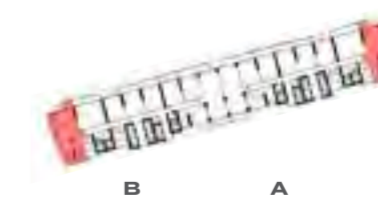

**TOWER A:**  
 LEVEL:  
 40  
**TOWER B:**  
 LEVEL:  
 40

# 3-BEDROOM LUXURY

TYPE B 01



B A

**SKY GARDEN TYPE 2**  
**TOWER A:**  
 LEVELS:  
 15,27  
**TOWER B:**  
 LEVELS:  
 15,27

# 3-BEDROOM LUXURY

TYPE B 02



B A

**BALCONY TYPE 1**  
**TOWER A:**  
 LEVELS:  
 11,13,24,33



B A

**BALCONY TYPE 4**  
**TOWER B:**  
 LEVELS:  
 5,7,16,20,28

# 3-BEDROOM LUXURY

TYPE B 03



**BALCONY TYPE 2**  
**TOWER A:**  
 LEVELS:  
 10,14,25,35



**BALCONY TYPE 5**  
**TOWER B:**  
 LEVELS:  
 4,8,17,19,29,31

# 3-BEDROOM LUXURY

TYPE B 04



**BALCONY TYPE 3**  
**TOWER A:**  
 LEVELS:  
 12,23,26,34,36

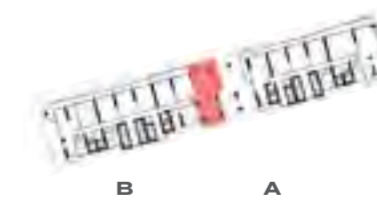

**BALCONY TYPE 6**  
**TOWER B:**  
 LEVELS:  
 3,6,18,30

# 3-BEDROOM LUXURY

TYPE B 05



B A

**SKY GARDEN TYPE 1**

**TOWER A:**  
LEVEL:  
9

**TOWER B:**  
LEVEL:  
9

# 3-BEDROOM LUXURY

TYPE B 06

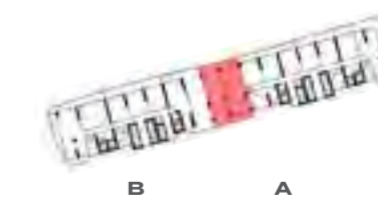

B A

**SKY GARDEN TYPE 3**

**TOWER A:**  
LEVELS:  
22,32

**TOWER B:**  
LEVELS:  
22,32

# 3-BEDROOM LUXURY

TYPE B 07



**TOWER B:**  
LEVEL:  
2

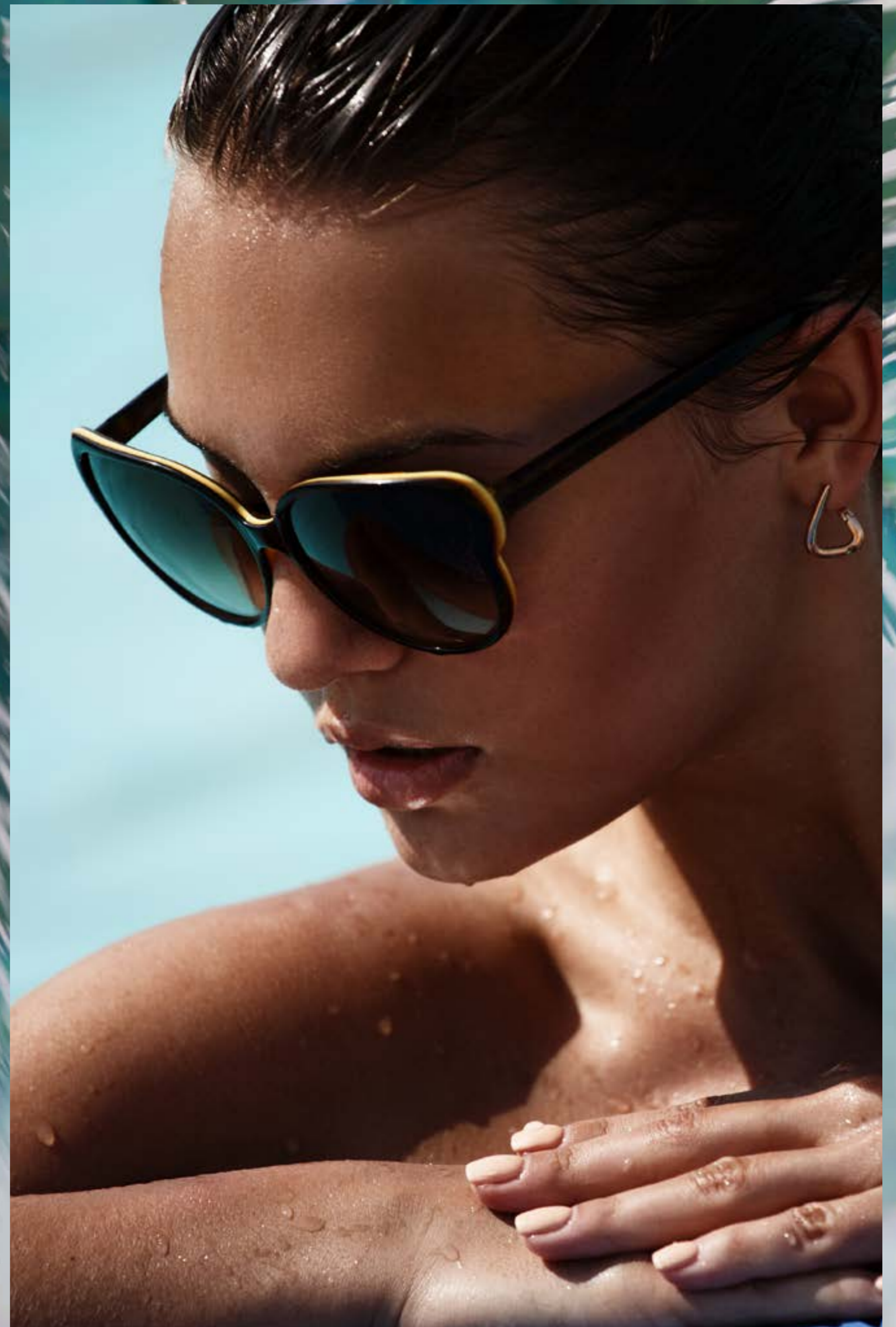

# 3-BEDROOM LUXURY

TYPE C 01



**TOWER A:**  
LEVEL:  
37

**TOWER B:**  
LEVEL:  
37

# 3-BEDROOM LUXURY

TYPE C 02

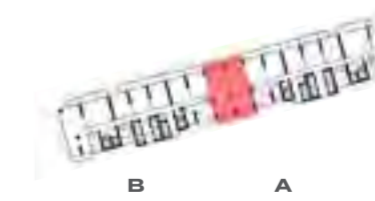

**TOWER A:**  
LEVEL:  
39

**TOWER B:**  
LEVEL:  
39

# 3-BEDROOM LUXURY

TYPE C 03

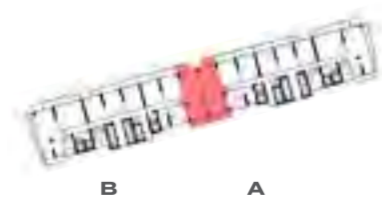

**TOWER A:**  
LEVEL:  
40

**TOWER B:**  
LEVEL:  
40

# 3-BEDROOM LUXURY

TYPE C 04

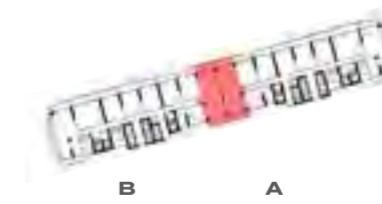

**TOWER A:**  
LEVELS:  
38, 41

**TOWER B:**  
LEVELS:  
38, 41

# 2-BEDROOM LUXURY

TYPE A 01



**SKY GARDEN TYPE 1  
TOWER B:**  
LEVEL:  
9



**SKY GARDEN TYPE 3  
TOWER B:**  
LEVELS:  
22,32

# 2-BEDROOM LUXURY

TYPE A 03

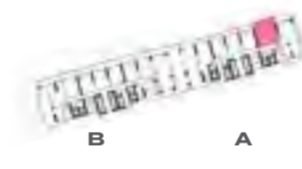

**SKY GARDEN TYPE 2  
TOWER A:**  
LEVELS:  
15,27

TYPE A 02



**TOWER A:**  
LEVEL:  
2

TYPE A 04



**BALCONY TYPE 1  
TOWER B:**  
LEVELS:  
12,26,36



**BALCONY TYPE 4  
TOWER A:**  
LEVELS:  
3,7,18,30

# 2-BEDROOM LUXURY

TYPE A 05

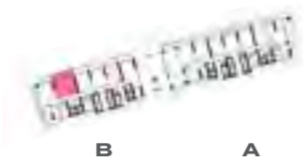

**BALCONY TYPE 2**  
**TOWER B:**  
LEVELS:  
10,14,23,25,34



**BALCONY TYPE 5**  
**TOWER A:**  
LEVELS:  
4,6,16,19,28,31

# 2-BEDROOM LUXURY

TYPE A 07



**TOWER B:**  
LEVEL:  
37

TYPE A 06



**BALCONY TYPE 3**  
**TOWER B:**  
LEVELS:  
12,23,26,34,36



**BALCONY TYPE 6**  
**TOWER A:**  
LEVELS:  
5,8,17,20,29

TYPE A 08



**TOWER A:**  
LEVEL:  
37

# 2-BEDROOM LUXURY

TYPE A 09



**TOWER A:**  
LEVEL:  
39

**TOWER B:**  
LEVEL:  
39

# 2-BEDROOM LUXURY

TYPE A 11



**TOWER A:**  
LEVELS:  
38, 41

**TOWER B:**  
LEVELS:  
38, 41

TYPE A 10



**TOWER A:**  
LEVEL:  
40

**TOWER B:**  
LEVEL:  
40

# 2-BEDROOM LUXURY

TYPE B 01



B A

**SKY GARDEN TYPE 1**  
**TOWER B:**  
 LEVEL:  
 9

# 2-BEDROOM LUXURY

TYPE B 02



B A

**SKY GARDEN TYPE 3**  
**TOWER B:**  
 LEVELS:  
 22, 32

# 2-BEDROOM LUXURY

TYPE B 03



**BALCONY TYPE 1**  
TOWER B:  
LEVELS:  
12, 26, 36



**BALCONY TYPE 4**  
TOWER A:  
LEVELS:  
3, 7, 18, 30

# 2-BEDROOM LUXURY

TYPE B 04



**BALCONY TYPE 2**  
TOWER B:  
LEVELS:  
10, 14, 23, 25, 34



**BALCONY TYPE 5**  
TOWER A:  
LEVELS:  
4, 6, 16, 19, 28, 31

# 2-BEDROOM LUXURY

TYPE B 05

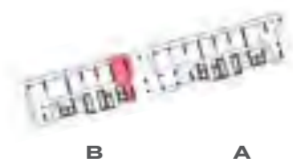

**BALCONY TYPE 3**  
TOWER B:  
LEVELS:  
11,13,24,33,35



**BALCONY TYPE 6**  
TOWER A:  
LEVELS:  
5,8,17,20,29

# 2-BEDROOM LUXURY

TYPE B 06



**SKY GARDEN TYPE 2**  
TOWER A:  
LEVELS:  
15,27

# 2-BEDROOM LUXURY

TYPE B 07



B A

**TOWER A:**  
LEVEL:  
2



# 2-BEDROOM LUXURY

TYPE C 01



**SKY GARDEN TYPE 1**  
**TOWER A:**  
 LEVEL:  
 9

# 2-BEDROOM LUXURY

TYPE C 02



**SKY GARDEN TYPE 3**  
**TOWER A:**  
 LEVELS:  
 22.32

# 2-BEDROOM LUXURY

TYPE C 03



**BALCONY TYPE 1**  
TOWER A:  
LEVELS:  
11,13,24,33



**BALCONY TYPE 4**  
TOWER B:  
LEVELS:  
5,7,16,20,28

# 2-BEDROOM LUXURY

TYPE C 04



**BALCONY TYPE 2**  
TOWER A:  
LEVELS:  
10,14,25,35



**BALCONY TYPE 5**  
TOWER B:  
LEVELS:  
4,8,17,19,29,31

# 2-BEDROOM LUXURY

TYPE C 05

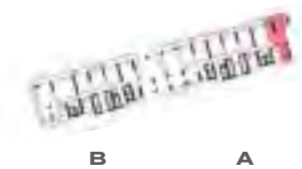

**BALCONY TYPE 3**  
TOWER A:  
LEVELS:  
12, 23, 26, 34, 36



**BALCONY TYPE 6**  
TOWER B:  
LEVELS:  
3, 6, 18, 30

# 2-BEDROOM LUXURY

TYPE C 06

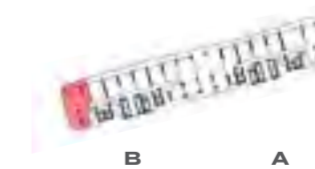

**SKY GARDEN TYPE 2**  
TOWER B:  
LEVELS:  
15, 27

# 2-BEDROOM LUXURY

TYPE C 07



B A

TOWER B:  
LEVEL:  
2



# 1-BEDROOM LUXURY

TYPE 01

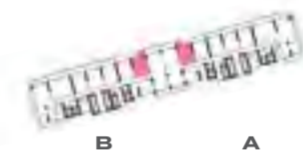

**TOWER A:**  
LEVELS:  
38, 41

**TOWER B:**  
LEVELS:  
38, 41

# 1-BEDROOM LUXURY

TYPE 03



**TOWER A:**  
LEVEL:  
40

**TOWER B:**  
LEVEL:  
40

TYPE 02

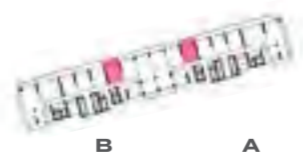

**TOWER A:**  
LEVELS:  
38, 41

**TOWER B:**  
LEVELS:  
38, 41

TYPE 04



**TOWER A:**  
LEVEL:  
40

**TOWER B:**  
LEVEL:  
40

# 1-BEDROOM LUXURY

TYPE 05



**TOWER A:**  
LEVEL:  
39  
**TOWER B:**  
LEVEL:  
39

# 1-BEDROOM LUXURY

TYPE 07



**TOWER A:**  
LEVEL:  
37  
**TOWER B:**  
LEVEL:  
37

TYPE 06



**TOWER A:**  
LEVEL:  
39  
**TOWER B:**  
LEVEL:  
39

TYPE 08

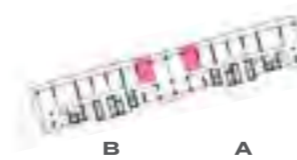

**TOWER A:**  
LEVEL:  
37  
**TOWER B:**  
LEVEL:  
37

# 1-BEDROOM LUXURY

TYPE 09



**BALCONY TYPE 6  
TOWER B:**  
LEVELS:  
3,6,18,30

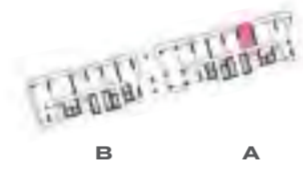

**BALCONY TYPE 3  
TOWER A:**  
LEVELS:  
12,23,26,34,36

# 1-BEDROOM LUXURY

TYPE 11



**BALCONY TYPE 6  
TOWER B:**  
LEVELS:  
3,6,18,30



**BALCONY TYPE 3  
TOWER A:**  
LEVELS:  
12,23,26,34,36

TYPE 10

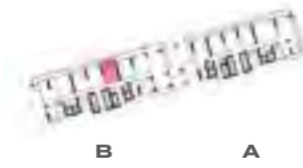

**BALCONY TYPE 6  
TOWER B:**  
LEVELS:  
3,6,18,30

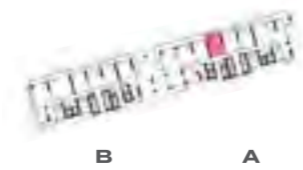

**BALCONY TYPE 3  
TOWER A:**  
LEVELS:  
12,23,26,34,36

TYPE 12



**BALCONY TYPE 6  
TOWER A:**  
LEVELS:  
5,8,17,20,29

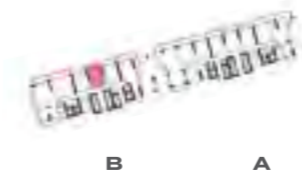

**BALCONY TYPE 3  
TOWER B:**  
LEVELS:  
11,13,24,33,35

# 1-BEDROOM LUXURY

TYPE 13

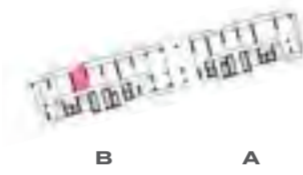

**BALCONY TYPE 5  
TOWER B:**  
LEVELS:  
4,8,17,19,29,31



**BALCONY TYPE 2  
TOWER A:**  
LEVELS:  
10,14,25,35

# 1-BEDROOM LUXURY

TYPE 15



**BALCONY TYPE 5  
TOWER B:**  
LEVELS:  
4,8,17,19,29,31

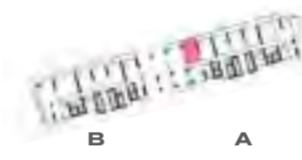

**BALCONY TYPE 2  
TOWER A:**  
LEVELS:  
10,14,25,35

TYPE 14



**BALCONY TYPE 5  
TOWER B:**  
LEVELS:  
4,8,17,19,29,31

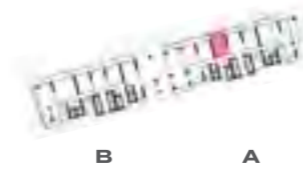

**BALCONY TYPE 2  
TOWER A:**  
LEVELS:  
10,14,25,35

TYPE 16



**BALCONY TYPE 5  
TOWER A:**  
LEVELS:  
4,6,16,19,28,31

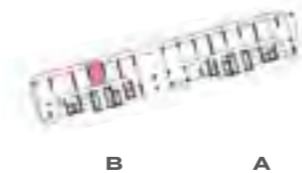

**BALCONY TYPE 2  
TOWER B:**  
LEVELS:  
10,14,23,25,34

# 1-BEDROOM LUXURY

TYPE 17



**BALCONY TYPE 4**  
**TOWER B:**  
 LEVELS:  
 5,7,16,20,28



**BALCONY TYPE 1**  
**TOWER A:**  
 LEVELS:  
 11,13,24,33

# 1-BEDROOM LUXURY

TYPE 19

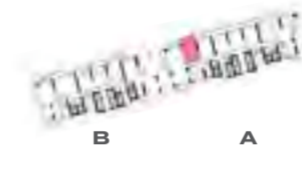

**BALCONY TYPE 1**  
**TOWER A:**  
 LEVELS:  
 11,13,24,33

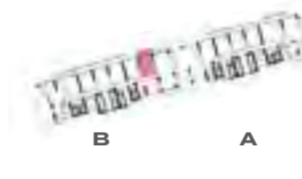

**TOWER B:**  
 LEVELS:  
 12,26,36

**BALCONY TYPE 4**  
**TOWER A:**  
 LEVELS:  
 3,7,18,30

**TOWER B:**  
 LEVELS:  
 5,7,16,20,28

TYPE 18

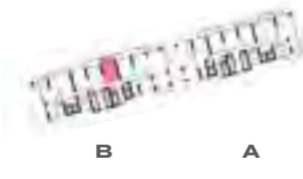

**BALCONY TYPE 4**  
**TOWER B:**  
 LEVELS:  
 5,7,16,20,28

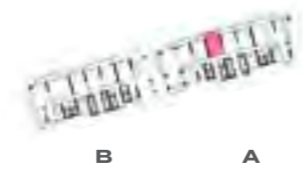

**BALCONY TYPE 1**  
**TOWER A:**  
 LEVELS:  
 11,13,24,33

TYPE 20



**BALCONY TYPE 1**  
**TOWER B:**  
 LEVELS:  
 12,26,36

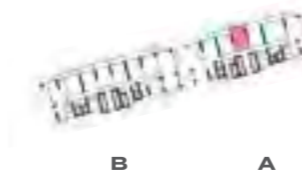

**BALCONY TYPE 4**  
**TOWER A:**  
 LEVELS:  
 3,7,18,30

# 1-BEDROOM LUXURY

TYPE 21



**BALCONY TYPE 2  
TOWER B:**  
LEVELS:  
10,14,23,25,34

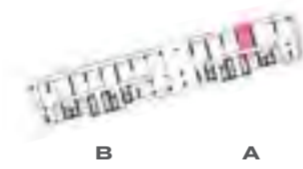

**BALCONY TYPE 5  
TOWER A:**  
LEVELS:  
4,6,16,19,28,31

# 1-BEDROOM LUXURY

TYPE 23



**BALCONY TYPE 5  
TOWER B:**  
LEVELS:  
4,8,17,19,29,31

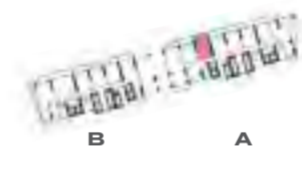

**BALCONY TYPE 2  
TOWER A:**  
LEVELS:  
10,14,25,35

TYPE 22

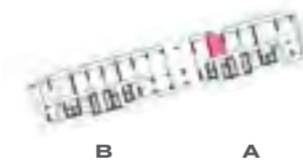

**BALCONY TYPE 5  
TOWER B:**  
LEVELS:  
4,8,17,19,29,31



**BALCONY TYPE 2  
TOWER A:**  
LEVELS:  
10,14,25,35

TYPE 24

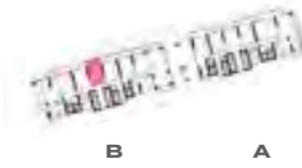

**BALCONY TYPE 5  
TOWER B:**  
LEVELS:  
4,8,17,19,29,31



**BALCONY TYPE 2  
TOWER A:**  
LEVELS:  
10,14,25,35

# 1-BEDROOM LUXURY

TYPE 25



**BALCONY TYPE 2  
TOWER A:**  
LEVELS:  
10,14,25,35

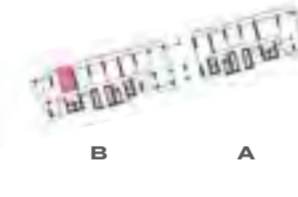

**BALCONY TYPE 5  
TOWER B:**  
LEVELS:  
4,8,17,19,29,31

# 1-BEDROOM LUXURY

TYPE 27

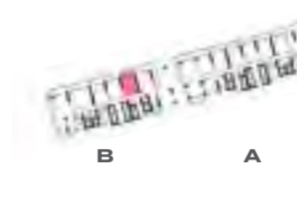

**BALCONY TYPE 3  
TOWER B:**  
LEVELS:  
11,13,24,33,35



**BALCONY TYPE 6  
TOWER A:**  
LEVELS:  
5,8,17,20,29

TYPE 26

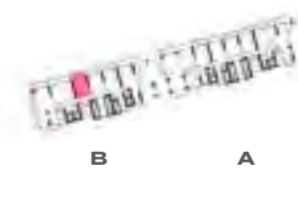

**BALCONY TYPE 3  
TOWER B:**  
LEVELS:  
11,13,24,33,35

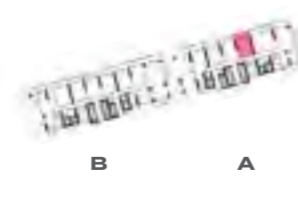

**BALCONY TYPE 6  
TOWER A:**  
LEVELS:  
5,8,17,20,29

TYPE 28



**BALCONY TYPE 3  
TOWER A:**  
LEVELS:  
12,23,26,34,36



**BALCONY TYPE 6  
TOWER B:**  
LEVELS:  
3,6,18,30

# 1-BEDROOM LUXURY

TYPE 29

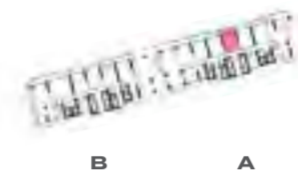

**BALCONY TYPE 3  
TOWER A:**  
LEVELS:  
12,23,26,34,36

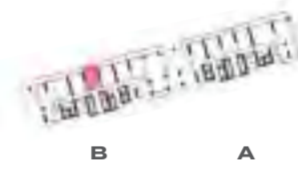

**BALCONY TYPE 6  
TOWER B:**  
LEVELS:  
3,6,18,30

# 1-BEDROOM LUXURY

TYPE 31

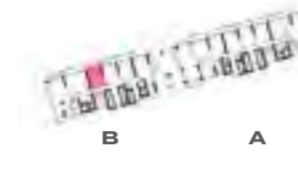

**BALCONY TYPE 1  
TOWER B:**  
LEVELS:  
12,26,36

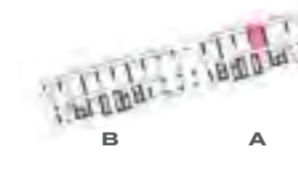

**BALCONY TYPE 4  
TOWER A:**  
LEVELS:  
3,7,18,30

TYPE 30



**BALCONY TYPE 3  
TOWER A:**  
LEVELS:  
12,23,26,34,36

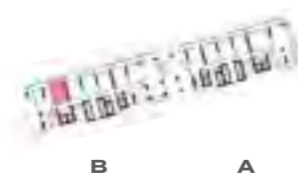

**BALCONY TYPE 6  
TOWER B:**  
LEVELS:  
3,6,18,30

TYPE 32



**BALCONY TYPE 1  
TOWER B:**  
LEVELS:  
12,26,36



**BALCONY TYPE 4  
TOWER A:**  
LEVELS:  
3,7,18,30

# 1-BEDROOM LUXURY

TYPE 33

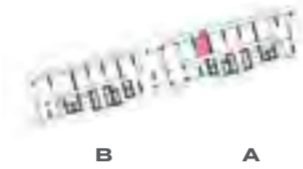

**BALCONY TYPE 1  
TOWER A:**  
LEVELS:  
11,13,24,33

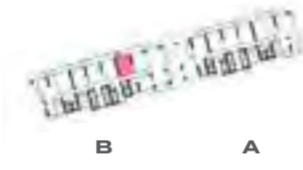

**BALCONY TYPE 4  
TOWER B:**  
LEVELS:  
5,7,16,20,28

# 1-BEDROOM LUXURY

TYPE 35

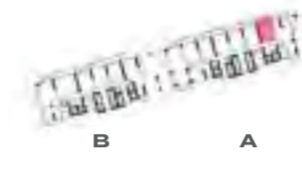

**BALCONY TYPE 1  
TOWER A:**  
LEVELS:  
11,13,24,33



**BALCONY TYPE 4  
TOWER B:**  
LEVELS:  
5,7,16,20,28

TYPE 34

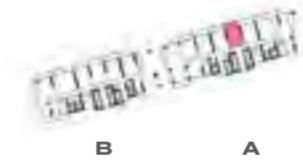

**BALCONY TYPE 1  
TOWER A:**  
LEVELS:  
11,13,24,33

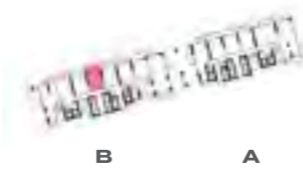

**BALCONY TYPE 4  
TOWER B:**  
LEVELS:  
5,7,16,20,28

TYPE 36



**TOWER B:**  
LEVEL:  
2



**SKY GARDEN TYPE 1  
TOWER B:**  
LEVEL:  
9



**SKY GARDEN TYPE 3  
TOWER B:**  
LEVELS:  
22,32

# 1-BEDROOM LUXURY

TYPE 37

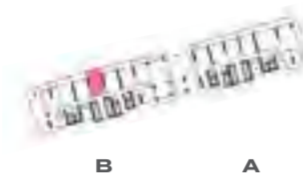

**TOWER B:**  
LEVEL:  
2

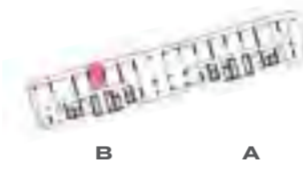

**SKY GARDEN TYPE 3**  
**TOWER B:**  
LEVELS:  
22,32

# 1-BEDROOM LUXURY

TYPE 39

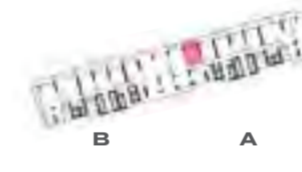

**SKY GARDEN TYPE 3**  
**TOWER A:**  
LEVELS:  
22,32

TYPE 38



**TOWER B:**  
LEVEL:  
2



**SKY GARDEN TYPE 3**  
**TOWER B:**  
LEVELS:  
22,32

TYPE 40



**SKY GARDEN TYPE 3**  
**TOWER A:**  
LEVELS:  
22,32

# 1-BEDROOM LUXURY

TYPE 41

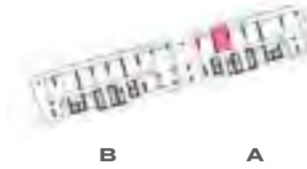

**TOWER A:**  
LEVEL:  
2



**SKY GARDEN TYPE 3**  
**TOWER A:**  
LEVELS:  
22,32

# 1-BEDROOM LUXURY

TYPE 43

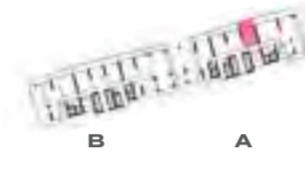

**TOWER A:**  
LEVEL:  
2

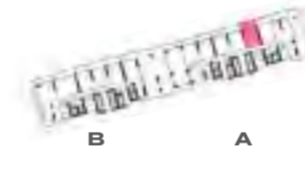

**SKY GARDEN TYPE 3**  
**TOWER A:**  
LEVELS:  
22,32

TYPE 42



**TOWER A:**  
LEVEL:  
2



**SKY GARDEN TYPE 3**  
**TOWER A:**  
LEVELS:  
22,32

TYPE 44



**SKY GARDEN TYPE 3**  
**TOWER A:**  
LEVELS:  
22,32

# 1-BEDROOM LUXURY

TYPE 45



**SKY GARDEN TYPE 2  
TOWER B:**  
LEVELS:  
15,27

# 1-BEDROOM LUXURY

TYPE 47



**SKY GARDEN TYPE 1  
TOWER B:**  
LEVEL:  
9



**SKY GARDEN TYPE 2  
TOWER B:**  
LEVELS:  
15,27

TYPE 46



**SKY GARDEN TYPE 2  
TOWER B:**  
LEVELS:  
15,27

TYPE 48



**SKY GARDEN TYPE 1  
TOWER B:**  
LEVEL:  
9



**SKY GARDEN TYPE 2  
TOWER B:**  
LEVELS:  
15,27

# 1-BEDROOM LUXURY

TYPE 49



**SKY GARDEN TYPE 2  
TOWER B:**  
LEVELS:  
15,27

# 1-BEDROOM LUXURY

TYPE 51



**SKY GARDEN TYPE 1  
TOWER B:**  
LEVEL:  
9

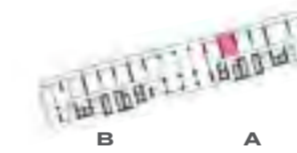

**SKY GARDEN TYPE 2  
TOWER A:**  
LEVELS:  
15,27

TYPE 50



**SKY GARDEN TYPE 2  
TOWER B:**  
LEVELS:  
15,27

TYPE 52



**SKY GARDEN TYPE 2  
TOWER A:**  
LEVELS:  
15,27

# 1-BEDROOM LUXURY

TYPE 53



**SKY GARDEN TYPE 2**  
**TOWER A:**  
 LEVELS:  
 15,27

# 1-BEDROOM LUXURY

TYPE 55

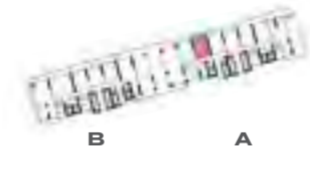

**SKY GARDEN TYPE 1**  
**TOWER A:**  
 LEVEL:  
 9

TYPE 54



**SKY GARDEN TYPE 1**  
**TOWER A:**  
 LEVEL:  
 9

TYPE 56



**SKY GARDEN TYPE 1**  
**TOWER A:**  
 LEVEL:  
 9

# 1-BEDROOM LUXURY

TYPE 57

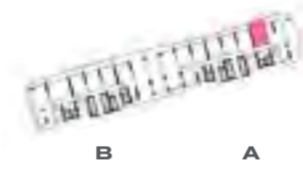

**SKY GARDEN TYPE 1**  
**TOWER A:**  
**LEVEL:**  
9

# 1-BEDROOM LUXURY

TYPE 59



**TOWER B:**  
**LEVEL:**  
2

TYPE 58



**TOWER B:**  
**LEVEL:**  
2

TYPE 60



**TOWER B:**  
**LEVEL:**  
2

# 1-BEDROOM LUXURY

TYPE 61

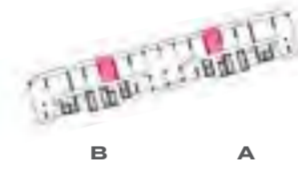

**TOWER A:**  
LEVEL:  
39

**TOWER B:**  
LEVEL:  
39

# 1-BEDROOM LUXURY

TYPE 63



**TOWER A:**  
LEVEL:  
39

**TOWER B:**  
LEVEL:  
39

TYPE 62



**TOWER A:**  
LEVEL:  
39

**TOWER B:**  
LEVEL:  
39

TYPE 64



**TOWER A:**  
LEVEL:  
37

**TOWER B:**  
LEVEL:  
37

# 1-BEDROOM LUXURY

TYPE 65



**TOWER A:**  
LEVEL:  
37

**TOWER B:**  
LEVEL:  
37

# 1-BEDROOM LUXURY

TYPE 67

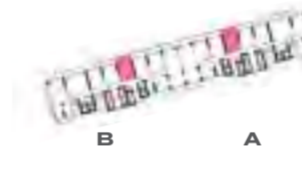

**TOWER A:**  
LEVEL:  
40

**TOWER B:**  
LEVEL:  
40

TYPE 66

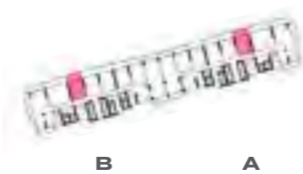

**TOWER A:**  
LEVEL:  
37

**TOWER B:**  
LEVEL:  
37

TYPE 68



**TOWER A:**  
LEVEL:  
40

**TOWER B:**  
LEVEL:  
40

# 1-BEDROOM LUXURY

TYPE 69

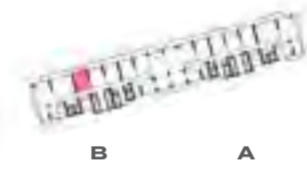

**TOWER B:**  
LEVEL:  
40

# 1-BEDROOM LUXURY

TYPE 71

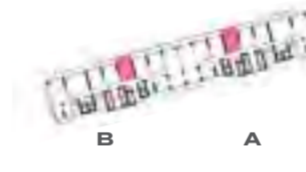

**TOWER A:**  
LEVELS:  
38,41  
**TOWER B:**  
LEVELS:  
38,41

TYPE 70



**TOWER A:**  
LEVELS:  
38,41  
**TOWER B:**  
LEVELS:  
38,41

TYPE 72



**TOWER A:**  
LEVELS:  
38,41  
**TOWER B:**  
LEVELS:  
38,41

# DAMAC PROPERTIES

## LIVE THE LUXURY

DAMAC Properties has been at the forefront of the Middle East's luxury real estate market since 2002, delivering award-winning residential, commercial and leisure properties across the region, including the UAE, Saudi Arabia, Qatar, Jordan, Lebanon, Iraq, Maldives, Canada, the United States, as well as the United Kingdom. Since then, the company has delivered approximately 43,700 homes, with a development portfolio of more than 28,000 at various stages of planning and progress.\*

Joining forces with some of the world's most eminent fashion and lifestyle brands, DAMAC has brought new and exciting living concepts to the market in collaborations that include a golf course managed by The Trump Organization, and luxury homes in association with Versace, Cavalli, Just Cavalli, de Grisogono, Paramount Hotels & Resorts, Rotana and the Radisson Hotel Group. With a consistent vision, and strong momentum, DAMAC Properties is building the next generation of Middle Eastern luxury living.

DAMAC places a great emphasis on philanthropy and corporate social responsibility. The Hussain Sajwani – DAMAC Foundation, a joint initiative between DAMAC Group and Hussain Sajwani, recently announced the launch of the 'Fresh Slate' in collaboration with the Dubai Police General Headquarters, aimed at aiding detainees in Dubai's Punitive and Correctional Institutions who have been charged with petty offences.

The HSDF has also pledged AED 5 million for the 1 Billion Meals initiative launched by Vice President and Prime Minister of the UAE, and Ruler of Dubai, His Highness Sheikh Mohammed bin Rashid Al Maktoum, at the start of Ramadan 2022, aimed at providing meals to underprivileged communities in 50 countries across the world.

DAMAC has also supported the vision of Sheikh Mohammed to train one million Arab coders in creating an empowered society through learning and skills development, an initiative that successfully wrapped up in May 2022.

\*As of 31<sup>st</sup> December 2022.

## LUXURY BY APPOINTMENT

CONTACT US AT ANY OF OUR OFFICES OR VISIT [DAMACPROPERTIES.COM](https://damacproperties.com)

### UNITED ARAB EMIRATES

Dubai  
Tel: 800-DAMAC (800-32622)  
E-mail: [dubai@damacgroup.com](mailto:dubai@damacgroup.com)

Park Towers – Sales Centre  
Dubai International Financial Centre

AYKON City – Sales Centre  
Floor 63, Sheikh Zayed Road

DAMAC Hills – Sales Centre  
Sheikh Zayed bin Hamdan Al Nahyan  
Street

DAMAC Hills – Sales Centre  
Golf Veduta, Townhouse TH2

DAMAC Hills – Sales Centre  
Bellavista (Carson Building)

DAMAC Hills 2 – Sales Centre  
Amazonia Cluster, Villa 333

DAMAC Hills 2 – Sales Centre  
Water Town

### QATAR

Building 90, New Solta Area  
Ali bin Abi Talib Street  
Next to Omar bin Al Khattab  
Health Centre  
Tel: +974 44 666 986  
Fax: +974 44 554 576  
E-mail: [doha@damacgroup.com](mailto:doha@damacgroup.com)

### KINGDOM OF SAUDI ARABIA

DAMAC Towers Riyadh  
South Tower  
Olaya District  
King Fahd Road  
PO Box 102460  
Tel: +966 11 835 0300  
E-mail: [ksa@damacgroup.com](mailto:ksa@damacgroup.com)

### TURKEY

Levazim, Mah. Koru Sk.  
Zorlu Centre No. 2  
IC Kapi No. 347, Beşiktaş/İstanbul  
Turkey  
Tel: +90 212 892 0327  
Fax: +90 212 890 7184  
E-mail: [turkey.office@damacgroup.com](mailto:turkey.office@damacgroup.com)

### LEBANON

Unit 1801, 18th Floor  
DAMAC Tower  
Omar Daouk Street  
Mina El Hosn, Beirut Central District  
Tel: +961 81 647 200  
E-mail: [beirut@damacgroup.com](mailto:beirut@damacgroup.com)

### JORDAN

Opposite Abdali Mall Gate #1  
Al Istithmar Street  
Abdali Project, Amman  
Tel: +962 6 510 7000  
Fax: +962 6 565 7896  
E-mail: [amman@damacgroup.com](mailto:amman@damacgroup.com)

### UNITED KINGDOM

4th Floor, 100 Brompton Road  
Opposite Harrods  
Knightsbridge, London  
SW3 1ER, United Kingdom  
Tel: +44 (0) 207 590 8050  
E-mail: [sales@damactower.co.uk](mailto:sales@damactower.co.uk)

***DAMAC***